

LEGEND

▼ BUILDING ENTRANCE
E.E. EMERGENCY EXIT

SITE AREA

TOTAL SITE APPLICATION AREA:
0.8256 Ha

SITE DEVELOPMENT AREA:
0.5500 Ha

ROAD WORKS IN APPLICATION AREA:
0.2756 Ha

OWNERSHIP

OWNERSHIP SITE BOUNDARY:
0.5714 Ha

LOCAL AUTHORITY ROAD WORKS
APPLICATION AREA:
0.2542 Ha

LAND TO BE TAKEN-IN-CHARGE
BY DCC

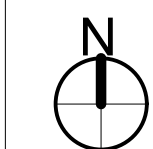

P5	27/01/23	ISSUED FOR PLANNING
P4	13/01/23	ISSUED FOR PRE-PLANNING
P3	06/10/22	ISSUED FOR PRE-PLANNING
P2	09/09/22	ISSUED FOR PRE-PLANNING
P1	25/08/22	ISSUED FOR PRE-PLANNING

Rev.	Date	Description
------	------	-------------

MALKEY LIMITED

STATUS PLANNING

PROJECT 158A RICHMOND ROAD

PROJECT ADDRESS 158A RICHMOND ROAD DUBLIN 3

DWG TITLE PROPOSED SITE PLAN - SCENARIO B (WITHOUT PH 1)

DWG NO. 22001-RKD-ZZ-00-DR-A-1002B

REV.	STATUS	PROJECT NO.
P5	A3	22001
DATE	DRN	CHK
JAN 2023	JB	HB

RKD

59 Northumberland Rd
Ballsbridge, Dublin 4
D04 VP86, Ireland

+353 1 668 1055
mail@rkd.ie
rkd.ie

1 1002 B_PROPOSED SITE PLAN
1 : 500

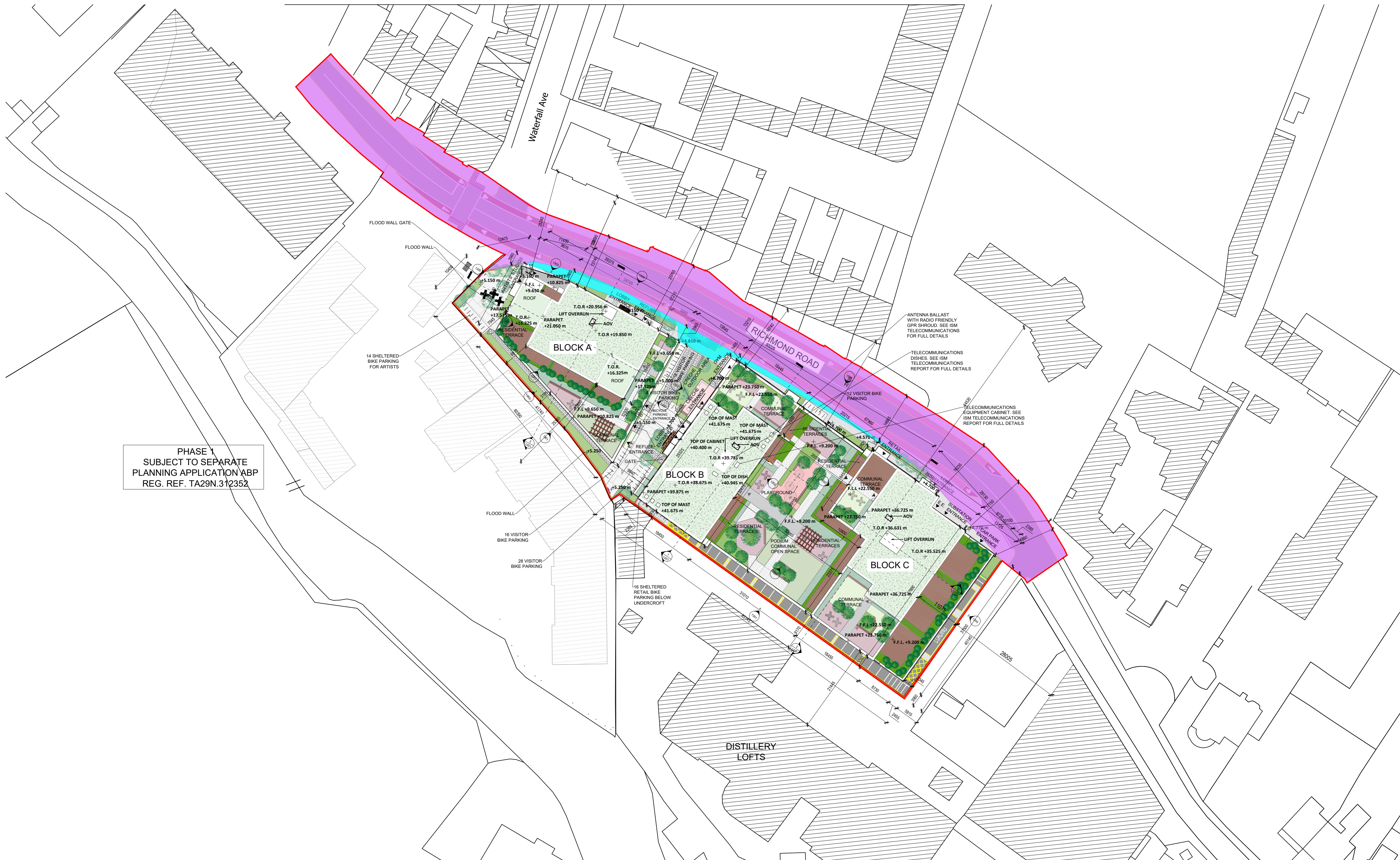

PHASE 1
SUBJECT TO SEPARATE
PLANNING APPLICATION ABP
REG. REF. TA29N.312352